

## PW090Z.MH

MBP-HBP Reciprocating Compressor  
R134a 220-240V/50Hz  
DATASHEET

MODEL		PW090Z.MH	
Displacement (cc)	9.1		
Rated voltage / Frequency	220-240V/50Hz		
Refrigerant	R134a		
Oil quantity (cm <sup>3</sup> )			
Cooling	Fan cooling <b>F2</b>		
BASIC DATA			
Voltage range (V)	220-240V		
Application	MBP/HBP		
Evaporator Temperature Range (°C)	-15/15		
Maximum Ambient Temperature (°C)	43		
Expansion Device	Capillary tube		
Motor Type	CSIR		
PERFORMANCE PARAMETER			
Test conditions	ASHRAE (MBP) (0°C)		
Rated Watts (W) (≤115%)	312		
Rated current (A) (≤110%)	2.5		
COP (W/W) (≥95%)	1.80		
EER (BTU/Wh)	6.15		
ACCESSORIES			
Devices	Q.ty	Type	
Protector	1	PW090Z.MH	
Protector buckle	1		
Starting Relay (current)	1	Starting relay	
Cover	1		
Cover buckle	1		
Starting Capacitor	1	80MF	
Earth screw assembly	1		
Rubber mat	4		
Sleeve	4		
DIMENSIONS TABLE			
Height (mm)	185		
(S) Suction tube inner diameter (mm)	Ø 6.3±0.1		
(P) Process tube inner diameter (mm)	Ø 6.3±0.1		
(D) Discharge tube inner diam (mm)	Ø 6.0±0.1		
Compressors per pallet (pcs)			

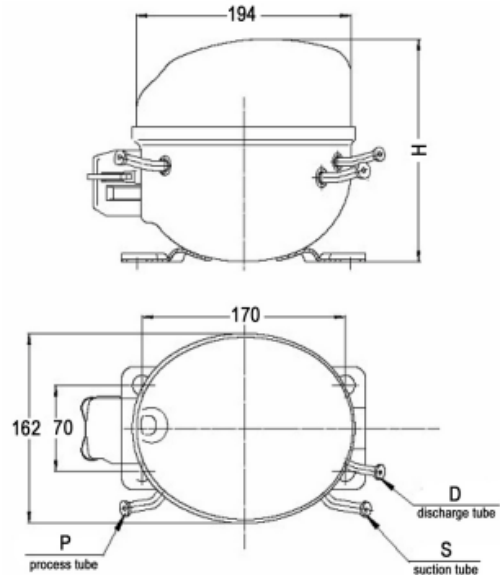

PERFORMANCE PARAMETER				
TEST CONDITIONS		Cond. Temp. 54.4°C – Amb. Temp. 35°C – Subcooling Temp. 46.1°C – Suction Temp. 35°C		
Test voltage	220V/50 Hz			
Evaporating Temp. (°C)		-10	-5	0
Cooling capacity (W) (≥95%)		374	472	562
Cooling capacity (KCAL/h)		322	406	483
Cooling capacity (BTU/h)		1276	1610	1917
				+7.2
				772
				664
				2634

